

ORDINANCE NO. 5684

AN ORDINANCE relating to the annexation of an area known as 75-1 to Southwest Suburban Sewer District.

STATEMENT OF FACT:

1. A notice of intention proposing the annexation of an area known as 75-1 to Southwest Suburban Sewer District was filed with the County Council August 27, 1981.

2. Southwest Suburban Sewer District has found the petition for annexation to be sufficient and has, by Resolution 81-24 concurred with the proposed annexation.

3. Southwest Suburban Sewer District filed a Declaration of Non-significant Impact dated June 29, 1981, on the proposed annexation.

4. The County Council held a public hearing on the 21st day of September, 19 81, and has considered the criteria set forth in RCW 56.02.060.

BE IT ORDAINED BY THE COUNCIL OF KING COUNTY:

SECTION 1. The annexation by Southwest Suburban Sewer District of the area known as 75-1 and described in Section 3 herein is approved. King County Council Annexation Report on 75-1 is attached and made a part of this ordinance.

SECTION 2. Completion of this annexation does not constitute county approval or disapproval of any other permits, certifications, or actions necessary to provide service to this annexation area.

SECTION 3. The area known as 75-1 to be annexed is described as follows:

1
2
3
4
5
6
7
8
9
10
11
12
13
14
15
16
17
18
19
20
21
22
23
24
25
26
27
28
29
30
31
32
33

1 Beginning at a Point on the North Line of the NE 1/4
2 of Section 25, Township 23, Range 3 East, W.M., which is
3 163 feet West of the West line of the East 1/2 of the
4 East 1/2 of the said NE 1/4 (which is also the center-
5 line 19th Ave. S.W.)

6 Thence Southerly parallel with said centerline to the
7 South line of North 1/2 of the NE 1/4 of the NW 1/4 of
8 the NE 1/4 of the NE 1/4 of Section 25 Township 23,
9 Range 3 East, W.M.;

10 Thence Westerly along said South line to its intersection
11 with a line 165 ft. West of and parallel to the centerline
12 of 19th Ave. S.W.;

13 Thence Southerly along said parallel line to its intersection
14 with a line 250 ft. South of and parallel to the North line
15 of said Section 25;

16 Thence Easterly along said parallel line to its intersection
17 with a line 150 feet West of and parallel to the centerline
18 of 19th Ave. S.W.;

19 Thence Southerly along said parallel line to its intersection
20 with a line 330 ft. South of and parallel to the North line
21 of said Section 25;

22 Thence Westerly along said parallel line to its intersection
23 with a line 180 ft. West of and parallel to the centerline
24 of 19th Ave. S.W.;

25 Thence Southerly along said parallel line to its intersection
26 with a line 84 ft. North of and parallel to the South line of
27 the N 1/2 of the S 1/2 of the NW 1/4 of the NE 1/4 of the
28 NE 1/4 of said Section 25;

29 Thence Easterly along said parallel line to its intersection
30 with a line 150 ft. West of and parallel to the centerline
31 of 19th Ave. S.W.;

32 Thence Southerly along said parallel line to its intersection
33 with the North line of the S 1/2 of the S 1/2 of the NW 1/4
of the NE 1/4 of the NE 1/4 of said Section 25;

Thence Westerly along said North line to its intersection
with the West line of the E 1/2 of the E 1/2 of the NW 1/4
of the NE 1/4 of the NE 1/4 of said Section 25;

Thence Southerly along said West line to its intersection
with a line 15 feet North of and parallel to the South line
of the NW 1/4 of the NE 1/4 of the NE 1/4 of said Section 25;

Thence Easterly along said parallel line to its intersection
with a line 120 feet West of and parallel to the centerline
of 19th Ave. S.W.;

Thence Southerly along said parallel line to its intersection
with the North line of the S 1/2 of the N 1/2 of the SW 1/4
of the NE 1/4 of the NE 1/4 of said Section 25;

1 Thence Westerly along said North line to its intersection
2 with a line 180 ft. West of and parallel to the center-
line of 19th Ave. S.W.;

3 Thence Southerly along said parallel line to its intersection
4 with a line 200 feet South of and parallel to the North line
5 of the S 1/2 of the SW 1/4 of the NE 1/4 of the NE 1/4 of
said Section 25;

6 Thence Westerly along said parallel line to its intersection
7 with the East line of the SW 1/4 of the SW 1/4 of the NE 1/4
8 of the NE 1/4 of said Section 25;

9 Thence Southerly along said East line to its intersection
10 with a line 130 feet North of and parallel to the center-
11 line of S.W. 164th St.;

12 Thence Westerly along said parallel line to its intersection
13 with a line 181.40 ft. East of and parallel to the West line
14 of the NE 1/4 of the NE 1/4 of said Section 25;

15 Thence Southerly along said parallel line to its intersection
16 with a line 121 feet North of and parallel to the center-
17 line of S.W. 164th St.;

18 Thence Westerly along said parallel line to its intersection
19 with a line 102 feet East of and parallel to the West line
20 of the NE 1/4 of the NE 1/4 of said Section 25;

21 Thence Northerly along said parallel line to its intersection
22 with a line 130 feet North of and parallel to the center-
23 line of S.W. 164th St.;

24 Thence Westerly along said parallel line to its intersection
25 with the West line of the NE 1/4 of the NE 1/4 of said
26 Section 25, also being the centerline of 21st Ave. S.W.;

27 Thence Southerly along the centerline of 21st Ave. S.W.
28 to its intersection with the Easterly extension of the North
29 line of Lot 5 of Assessor's Plat of Seaview Terrace accord-
30 ing to plat thereof recorded in Vol. 47 of Plats, Page 20,
31 Records of King County, Washington.

32 Thence Westerly along the North line of said Lot 5 to the
33 Northwest corner thereof;

Thence Northerly along the West line of the East 1/2 of the
NW 1/4 of the NE 1/4 of said Section 25 to its intersection
with a line 344 feet South of and parallel with the North
line of said Section 25;

Thence Easterly along said parallel line to a point which
is 537.86 feet Westerly of the centerline of 21st Ave. S.W.;

Thence Northwesterly to a point on the South line of the
North 220 feet of the said NE 1/4 which is 594.86 feet
West of the centerline of 21st Ave. S.W.;

Thence Westerly along said South line to its intersection
with a line which is 609.53 feet Westerly of and parallel
with the centerline of said 21st Ave. S.W.;

1 Thence Northerly along said parallel line 190 feet;

2 Thence Westerly parallel with the North line of said
3 Section 25 a distance of 44 feet;

4 Thence Northerly parallel with the centerline of 21st Ave.
5 S.W. to the intersection of the said North line of
6 Section 25;

7 Thence Easterly along said North line to the Point of
8 Beginning.

9 INTRODUCED AND READ for the first time this 8th day of
10 September, 19 81.

11 PASSED this 21st day of September, 19 81.

12 KING COUNTY COUNCIL
13 KING COUNTY, WASHINGTON

14 Paul Warden
15 Chairman

16 ATTEST:

17 Dorothy M. Ravens
18 DEPUTY Clerk of the Council

19 APPROVED this 1st day of October, 19 81.

20 [Signature]
21 King County Executive

DATE: September 17, 1981

Attachment

Proposed Ord. No. 81-618 5684

KING COUNTY COUNCIL

ANNEXATION REPORT

SW Suburban Sewer District

Annexation of 75-1

Files: BRB Temporary File #7-7

I. BUILDING AND LAND DEVELOPMENT DIVISION REPORT:

BALD Recommendation: Approve

This property is within the Highline Community Planning Area which recommends that this property be eligible for sewer service.

BACKGROUND INFORMATION

Size of Parcel: 33 Acres

Community Planning Area: Highline

Council District: #7

Existing Zoning and Land Use: The property is presently zoned RS-7200 and is developed with single-family residences. There are several parcels which could be further subdivided if sewers were installed.

II. COUNCIL STAFF RECOMMENDATION:

APPROVE.

PUGET SOUND

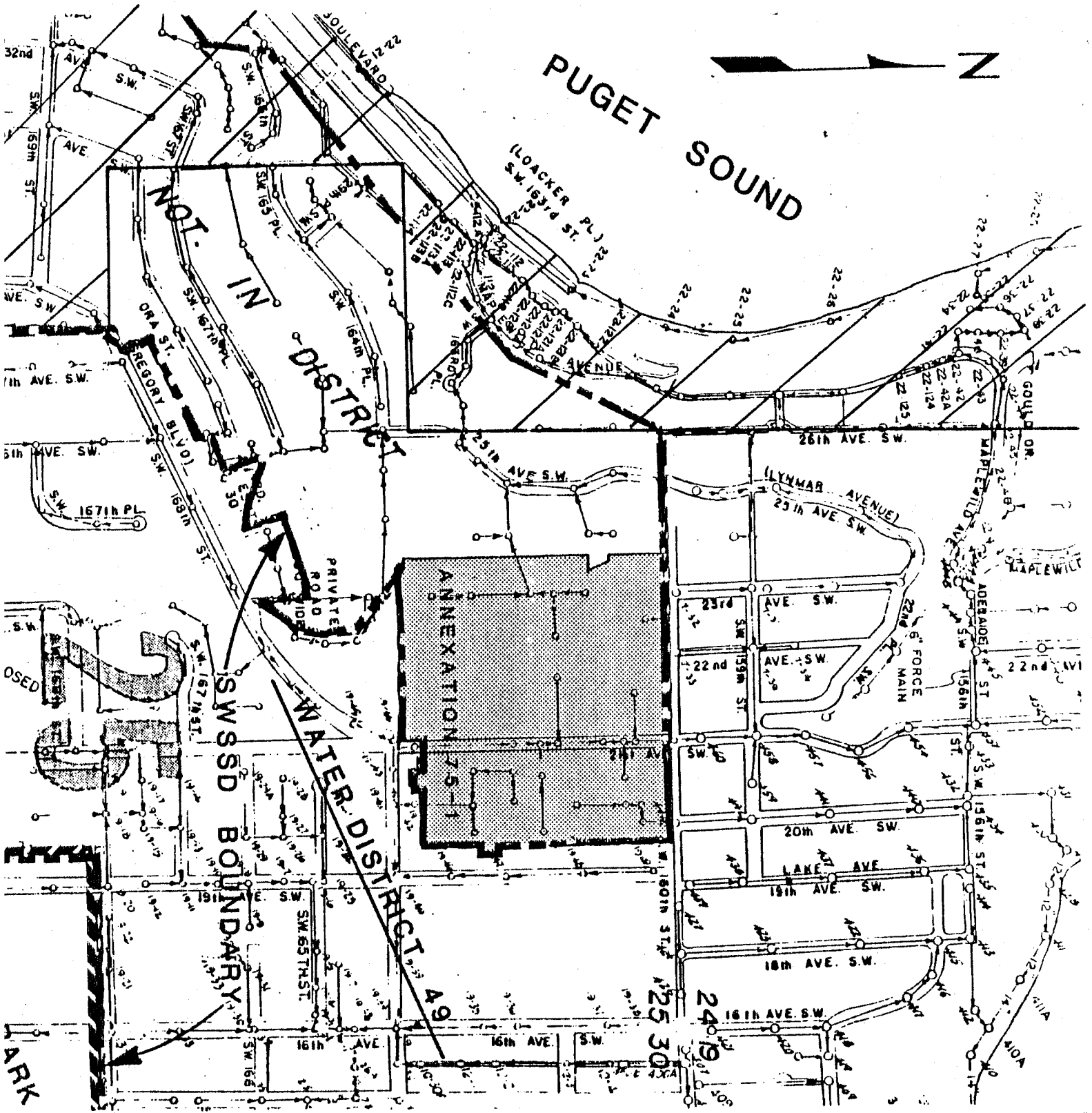
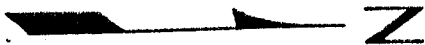

NOT IN DISTRICT

ANNEXATION 15-1

SWSSD BOUNDARY

WATER DISTRICT A9

MARK